

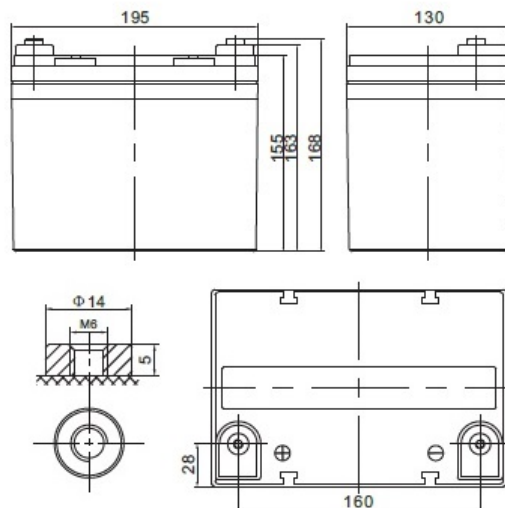

Nominal voltage	12 V	
Nominal capacity	35,2 Ah @ C20 to 1,75 V/cell 33,0 Ah @ C10 to 1,80 V/cell	
Dimensions	Length	195 mm
	Width	130 mm
	Height / Total height	155 / 168 mm
Weight	~ 9,7 kg	
Technology	VRLA (Valve Regulated Lead Acid) AGM (Absorbent Glass Mat)	
Design life time	12 years (standby use)	
Internal resistance	~ 12,0 mΩ (full charged)	
Operating temperature range	Discharge	-20°C ~ +60°C
	Charge	0°C ~ +50°C
	Storage	-20°C ~ +60°C
Maximum discharge current	330 A (5 sec.)	
Short circuit current	800 A	
Recommended maximum charging current	9,9 A	
Charging voltage	Standby use	13,6 ~ 13,8 VDC
	Cycle use	14,6 ~ 14,8 VDC
Self discharge	Monthly is less than 3% at 25°C	
Container material	ABS UL94HB (optional UL94-V0)	
Terminal types	Internal thread M6 (breaking torque 8-10Nm)	



CONSTANT CURRENT DISCHARGE CHARACTERISTICS (A at 25°C)

Voltage / Time	10 min	15 min	30 min	1 h	2 h	3 h	4 h	5 h	8 h	10 h	20 h
9.6 V	69,3	57,1	32,6	22,3	12,7	9,08	7,33	6,30	4,12	3,36	1,81
10.0 V	63,2	52,9	31,0	21,6	12,3	8,77	7,11	6,21	4,05	3,34	1,79
10.2 V	60,0	51,4	30,4	21,2	12,1	8,45	7,01	6,15	4,02	3,32	1,78
10.5 V	56,1	47,8	29,4	20,3	11,8	8,25	6,86	5,58	3,97	3,31	1,76
10.8 V	51,4	44,8	28,8	19,8	11,5	8,18	6,72	5,50	3,92	3,30	1,75
11.1 V	46,2	41,3	28,0	19,1	11,2	8,11	6,54	5,46	3,86	3,28	1,74

CONSTANT POWER DISCHARGE CHARACTERISTICS (W at 25°C)

Voltage / Time	10 min	15 min	30 min	1 h	2 h	3 h	4 h	5 h	8 h	10 h	20 h
9.6 V	732,0	600,0	391,8	245,4	139,8	104,4	85,2	73,2	47,88	39,18	20,70
10.0 V	678,0	584,4	368,4	241,8	137,4	102,6	81,6	70,2	47,16	38,76	20,46
10.2 V	660,0	574,2	360,0	239,4	135,6	100,8	80,4	69,0	46,80	38,58	20,34
10.5 V	624,0	552,0	348,0	234,6	130,8	96,0	78,0	67,8	46,32	38,28	20,16
10.8 V	586,2	534,0	336,0	232,8	126,0	91,2	75,6	66	45,84	37,98	19,98
11.1 V	534,6	505,8	325,2	230,4	121,2	87,0	73,8	64,2	45,30	37,68	19,74

According with:

PN-EN 60896-21:2007
PN-EN 60896-22:2007
PN-EN 61056-1:2013
PN-EN 61056-2:2013
PN-E-83016:1999
ISO 9001
ISO 14001

EFFECT OF TEMPERATURE ON LONG TERM LIFE

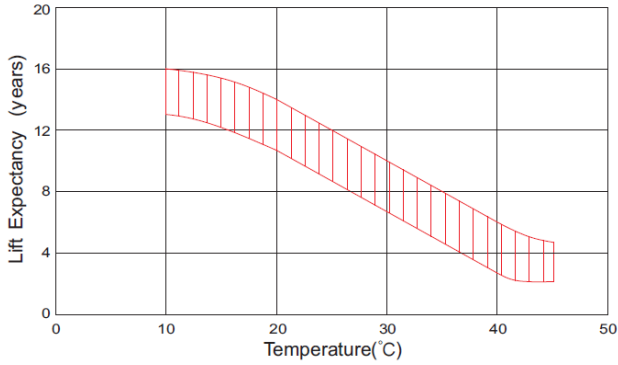

CYCLE LIFE IN RELATION TO DEPTH OF DISCHARGE

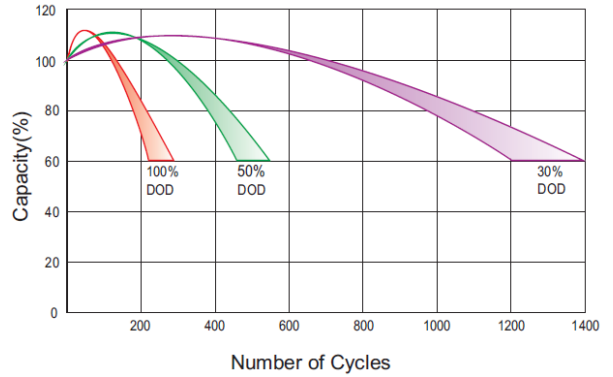

DISCHARGE CHARACTERISTICS

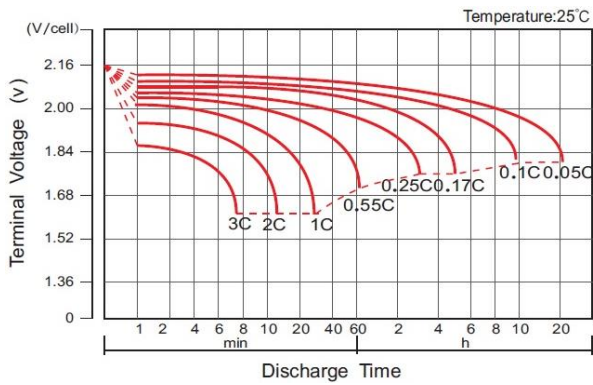

CHARGE CHARACTERISTIC FOR STANDBY USE

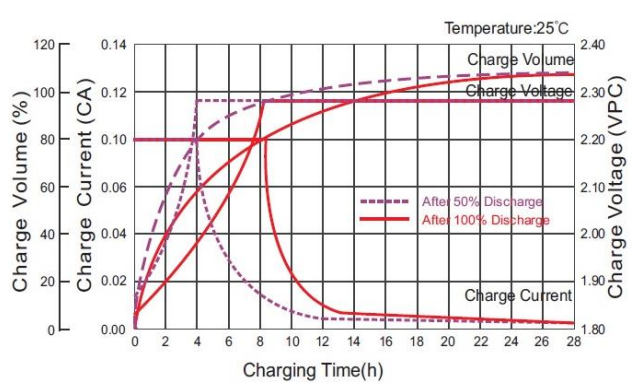

RELATIONSHIP BETWEEN CHARGING VOLTAGE AND TEMPERATURE

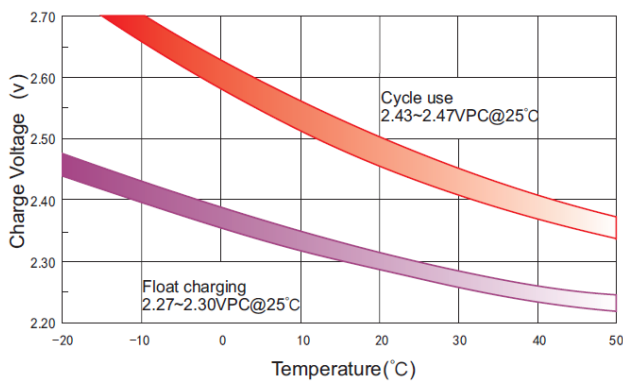

STORAGE CHARACTERISTICS

